

Welcome to Brownsea Island

Your Brownsea adventure starts here. Waymarked walking trails take you across the island to the visitor centres, bird hides, beaches, natural play area and much more. Take a walk through the woodland or down to the lagoon and you'll see a variety of wildlife from birds and squirrels to dragonflies and butterflies. Enjoy your visit to Brownsea!

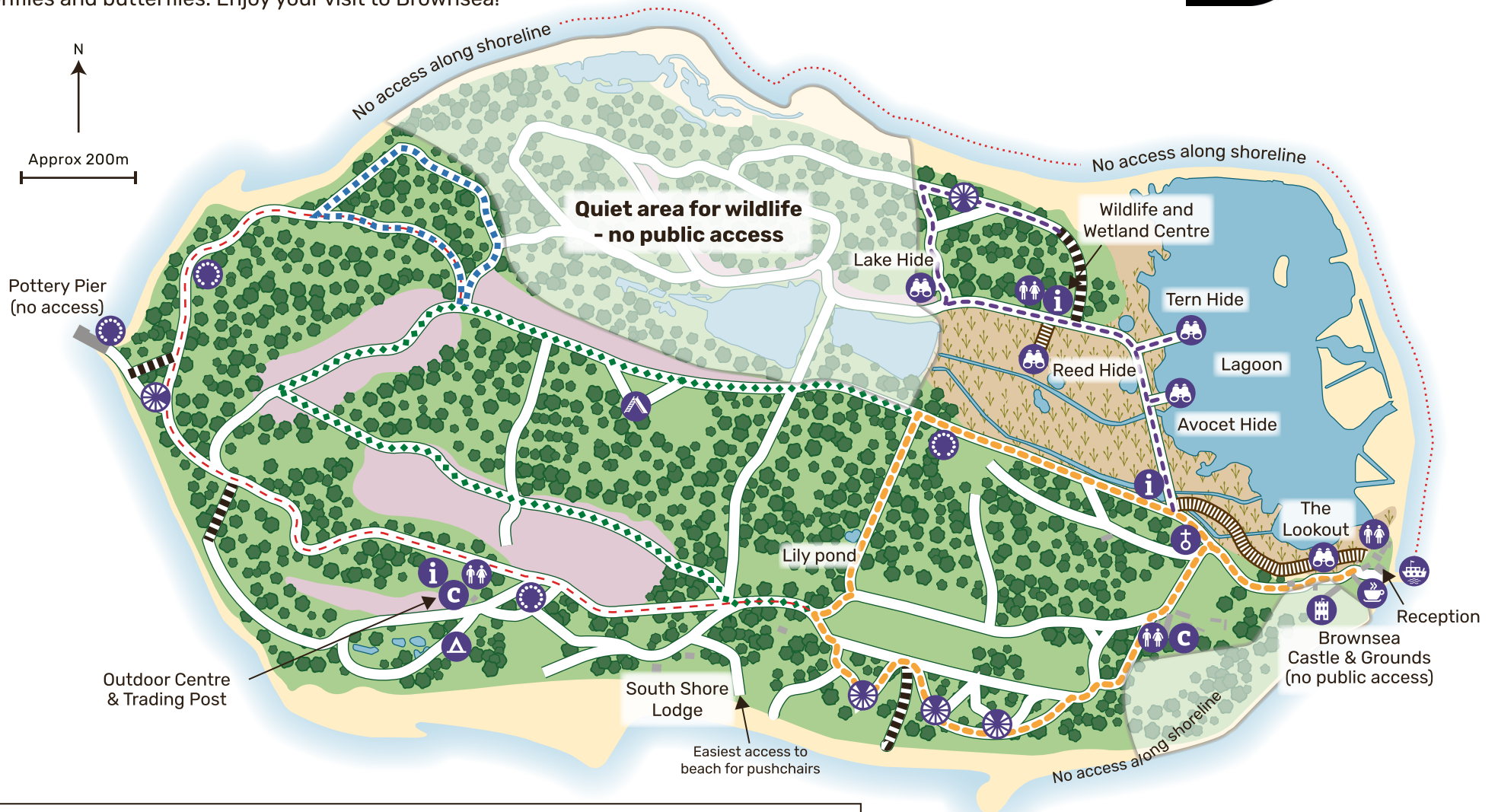

Map produced by Dorset Wildlife Trust. Contains OS data © Crown copyright database 2021.

- Trails:
- Wildlife & Wetlands walk (45 minutes, some steps)
 - Viewpoints and Woodland walk (1 hour)
 - Heathland walk (40 minutes)
 - Scouting and Maryland walk (35 minutes)
 - Calming Cambridge woods walk (20 minutes)